

# SUBMERSIBLE?

## WE HAVE YOUR VALVE.

- > Watertight and Corrosion Resistant for Direct Deep Sea Ocean Submersion
- > Depths to ~1000 Feet
- > Media Pressures up to 5000 PSI
- > Engineered to Aid with Environmental Causes



### TECHNICAL SPECIFICATIONS

Valve Type: 2-Way Normally Closed

Power Consumption: 14 Watts

Operating Pressure: Up to 5000 PSI

DC Voltages Available: 9, 12, 18, 24

Coil Option: Momentary Latching Coil Available

Submersible Depth: ~1000 Feet (and still testing)

External Materials: Nickel Plated Brass, Plastic Epoxy  
Coil and Housing

Consult factory for more details.

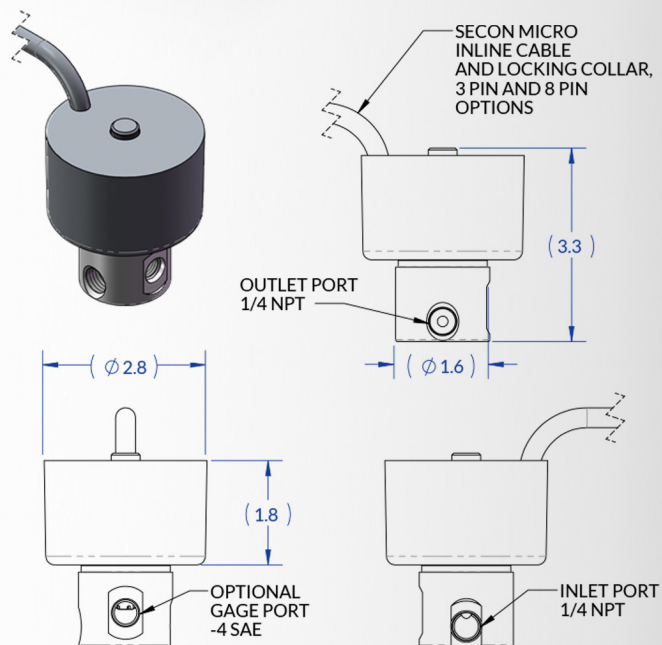

480 John Downey Drive  
New Britain CT 06051  
860-229-4884  
[peterpaul.com](http://peterpaul.com)