



Series 80 >> Model E829 C/I Rated

Large Orifice, Linked-Piloted – 2-Way Normally Closed Valve

Large orifice Automatic Safety Shut Off Valves designed specifically for gas appliances. These valves meet the standards for Commercial/Industrial (C/I) Safety Shut Off Valves per ANSI Z21.21 (CSA 6.5). They are well suited for use in heating equipment, furnaces, ovens, kilns, boilers and gas generators.

- Large orifice.
- High flow at high and low pressures.

OPERATING CONDITIONS

Media: Fuel gases.

Valve Temperature Range: Standard Valves - -40°F (-40°C) to 150°F (65°C) ambient and media temperatures.

Maximum Operating Pressure Differentials: See table on next page.

Burst Pressure: 0 PSI

Leakage: Bubble tight.

Vacuum: To 5 Microns*

ELECTRICAL CHARACTERISTICS

Coil Voltage: 120/60 and 12, 24/DC

Nominal Power: AC – 7.3 Watts, DC – 9.5 Watts

Coil Construction: Potted Class F

Operating Speed: Up to 100 CPM

Duty Cycle: Continuous

MECHANICAL CHARACTERISTICS

Body: Aluminum

Internal Components: Stainless Steel (Std.). Copper - AC Only.

Elastomers: Nitril (Buna) (Std.).

Orifice Diameter: See table on next page.

Porting: 1/2" NPT **Housing:** 1/2" NPT conduit - many options available.*

Listings: Valves are UL listed and CSA certified for Hazardous Locations – Class I, Div 1, Group C and D - Class II, Div 1, Group E, F, and G

Life Expectancy: Millions of cycles, depending on application, lubrication, etc.

Valve Weight: 2.20 lbs

Repair Packs: See table on next page.

* Consult representative or factory for options and specifications.

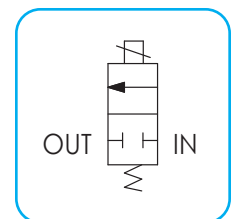
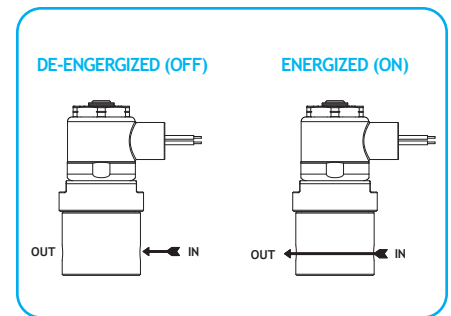

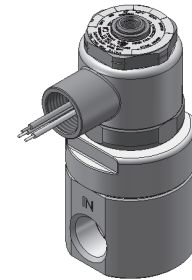
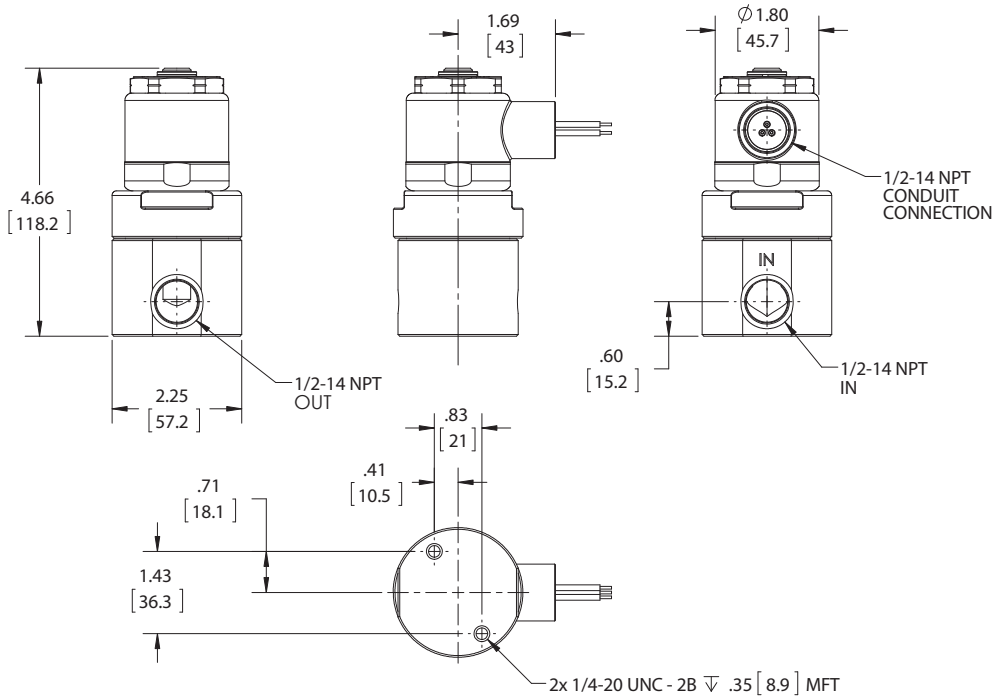

SERIES 80 MODEL E829 C/I
1/2" NPT PORTS
2WNC INTERNAL LINKED PILOT
EXPLOSION PROOF

VALVE SPECIFICATIONS

MAX. OPER. PRESS. DIFF.		MIN. OPER. PRESS. DIFF.	GAS CAPACITY BTU/HR	CV FACTOR	PIPE SIZE	VALVE NUMBER
AC	DC	N.C.	N.C.			
60	60	0	2,751,000	3.0	1/2 NPT	E829B11DCCP-SC

ORDERING INFORMATION:

WHEN ORDERING VALVES OR REPAIR PACKS ADD VOLTAGE AND FREQUENCY TO COMPLETE VALVE NUMBER. EXAMPLES: VALVE (829B11DGM 120/60) REPAIR PACK (K829BD AC)

NO OPERATOR AVAILABLE